

EM PRESS LIMITED EDITION 2003

EM PRESS



2003  
LIMITED EDITION

▶  
LEADING

THE

WAY  
▶



S = Standard    O = Option

# STANDARDS AND OPTIONS

A3902FB

## VEHICULAR

Air Brakes - c/w Slack Adjusters	S
Air Conditioner - Chassis	S
Air Horns	S
Air Suspension - c/w Bilstein Shock Absorbers	S
Alternator - 160 Amp	S
Block Heater (1000 W) with Switch in Bedroom	S
Bumpers - Integrated Fiberglass – Steel Reinforced	S
Chassis – IFS Freightliner c/w Cummins 400 HP Turbo Diesel (XC Series) Raised Rail, Side Radiator – GVWR 32,000 lbs	S
Compass/Thermometer - Dash Mounted Directional Compass with Exterior Temperature Readout	S
Cruise Control	S
Door - Driver Door c/w Power Window	S
Exhaust Brake	S
Fans - Chrome Cockpit Ventilating with Dash Switch	S
Fuel Fill - Concealed Locking Fuel Fill Access On Both Sides	S
Headlights - Styled with Xenon Bulbs	S
Hitch - Trailer Hitch Receiver w/ wiring and plug - Class III	S
Jacks - Automatic HWH Levelling System c/w Auto Air Dump	S
Light - High Mount Stoplight – LED Long Life	S
Lights - Halogen Automotive Driving Lights	S
Mats - Driver/Passenger Floor mats	S
Mirrors - Heated Remote Chrome Power Mirrors	S
Mud Guard - Monogrammed Triple E Rear Mudguard (Stainless Steel on Rubber)	O
Rust Protection	O
Steering Wheel - with Leather Cover, VIP Controls include	
Wiper and Washer Tilt/Telescopic	S
Switch - Battery Selector for Radio	S
Switch - Battery Boost (Coach to Chassis Batteries)	S
Tires - Michelin Radial 275/80R22.5XZE	S
Transmission - Allison 3000 MH Six Speed Automatic c/w Lock Up	S
Transmission Cooler	S
Undercoating - Automotive Type	S
Wheels - Alcoa Aluminium	S
Wipers - Wet Arm Windshield Wipers c/w Intermittent Function	S

## CONSTRUCTION

Baggage Doors - Aluminium Baggage Doors c/w Gas Struts and Slam Latches	S
Fiberglass Molded Front & Rear Mask	S
Lined and Lighted Baggage Compartments	S
Roof - Domed Sunguard® FRP Flexroof	S
Steel Cab Floor, Firewall and Dash Structure	S
Vacuum Bonded Aluminium Framed Insulated Sidewall & Roof Construction With Thermal Break	S
Vacuum Bonded Gel Coat Fiberglass Sidewalls	S
Vacuum Bonded Steel Framed Insulated Floor Construction	S
Windows - Thermal Barrier Window System with Low E Coating	S

## COACH EXTERIOR

Door - Screened Entry Door with Deadbolt Lock	S
Exterior Shower	S
Graphics - Painted Exterior Graphics	S
Handle - Entry & Driver Door Assist Handles (Interior Mounted)	S
Ladder - Exterior Ladder c/w Detachable Lower Section	O
Lights - Deluxe Patio Lights (2)	S
Lights - Docking Lamps (2 Side, 2 Rear)	S
Paint - Full Body Exterior Paint with Clear Coat	S
Step - Electric Retractable Entry Step	S

## COACH INTERIOR

Bedsread - Decorative Bedsread c/w Throw Pillows	S
Blinds - Side Driver & Passenger Roller Blinds	S
Cabinetry - "Golden Maple" Cabinetry with Maple Fridge Insert	O
Cabinetry - Solid Oak Cabinet Face Frames and Paneling	S
Ceiling - Domed with Automotive "Soft Touch" Headliner	S
Cover - Pneumatic Powered Front Step Cover	S
Covers - Insulated Vent Covers	O
Detectors - Electronic Smoke, LP and CO Detectors	S
Doors - Sculptured Solid Oak Panel Cabinet Doors	S
Drawers - Dual Roller Glide Drawers c/w Travel Lock	S
Drawers - Slide Out Drawer Option in Washer/Dryer Cabinet (N/A with Washer/Dryer Option)	O
Fire Extinguisher - Dry Chemical	S
Flooring - Ceramic Tile in Entrance Area	S
Headboard - Fabric Wrapped	S
Latches - Snap Latches on all Cabinet Doors	S
Lighting - Courtesy Floor Lamps	S
Safe - Keylock Safebox	S
Shades - Day/Night Pleated c/w Bedroom Blackout	S
Skyllight - in Living Area	O
Slide Out - Bed Slide Out with Rear Wardrobe and Make Up Table	S
Storage - Easy Under Bed Storage/Engine Access c/w Gas Struts	S
Sun Visor - Power Driver's Sun Visor	S
Sun Visor - Power Passenger's Sun Visor	S
Tray - Dash Mounted Computer Tray	O

## FURNITURE

Booth Dinette - Booth Dinette With Slide Out Drawers and Solid Surface Pedestal Mount Table	O
Chair - Ultra Leather Recliner with Refreshment Center c/w Flip Table	
In Lieu of Ultra Leather Easy Bed on Passenger Side	O
Hide A Bed - Cloth Hide a Bed on Drivers Side with Air Coil Mattress c/w 110V Air Pump (Available with Recliner Option Only)	O
Hide A Bed - Ultra Leather Hide a Bed on the Driver's Side (Contrasting Color) c/w 110V Air Pump (Available with Recliner Option Only)	O
Mattress - Premium Residential Quality Queen Bed (60" x 80")	S
Seat - Ultra Leather 8 Way Power Seat with Power Foot Rest on Passenger Side	S
Seat - Ultra Leather Swivel Power Drivers & Passengers Captain Chairs with Integral Seat Belts - 8 Way Power	S

A3902FB

Sofa - Cloth Easy Bed on Drivers Side	S
Sofa - Cloth Flexsteel Versaflex Lounger on Driver's Side	0
Sofa - Ultra Leather Easy Bed Passenger Side	S
Sofa - Ultra Leather Versaflex Lounger on Driver's Side (contrasting color)	0
Table - Solid Surface Table c/w Oak Chairs (Maple if Option Chosen)	S

#### GALLEY FEATURES

Coffee Maker	S
Cook Top - Recessed Cook Top c/w High Output Sealed Burner	S
Countertop - Solid Surface Countertop c/w Matching Cutting Board Sink Covers	S
Cover - Recessed Bi Fold Range Cover	S
Fan - Thermostatically Controlled Fan in Living Area	S
Faucets - Deluxe Single Lever Faucet	S
Flooring - Ceramic Tile Flooring	S
Flooring - Thermostatically Controlled Heating Element Under Ceramic Tile in Galley	S
Micro/Convection Oven - (OTR) c/w 110v Range Hood and Light	S
Oven - LP Gas Oven	0
Refrigerator - Dometic® Side by Side 12 cu. Ft. c/w Ice Maker LP/Electric	S
Refrigerator Inserts - Raised Sculptured Solid Oak Fridge Inserts	S
Sink - Recessed Solid Surface Sink	S
Water Purifier	S

#### LAVATORY

Countertop - Solid Surface Counter and Basin	S
Fan - Thermostatically Controlled Fan in Bath	S
Fan - Thermostatically Controlled Non Reversible Fan in Toilet Room	S
Faucet - Deluxe Faucets	S
Flooring - Ceramic Tile Flooring	S
Flooring - Thermostatically Controlled Heating Element Under Ceramic Tile in Lavatory	S
Shower - Neo Angle Fiberglass Enclosed Shower	0
Skylight – Shower Compartment	S
Toilet - Aurora China Toilet c/w Water Saver With Sprayer	S
Tub - Enclosed Fiberglass Garden Tub	S
Washer/Dryer Prep - for Washer/Dryer option	S
Window - with Valance and Venetian Blind in Toilet Room	S

#### ENTERTAINMENT

CB Antenna - includes Coax Lead in under Dash	0
DVD/VCR - Combination Unit in Lieu of VCR	0
Master Control - Audio/Video Master Control Switch Box	S
Pre-wire - Satellite Dish Pre-wire (with 12V Power)	S
Stereo - AM/FM Cassette in Dash Stereo w/ Separate 6 Disk CD Changer with Big Buttons - 80 Watt	0
Stereo - DHS Mobile Theatre System with AM/FM CD Stereo with 6 Stack in Dash CD Changer w/ Big Buttons - 80 Watt	S
Stereo - Exterior AM/FM – CD Stereo with Shielded Speakers	0
Stereo - Separate AM/FM CD Stereo in Bedroom c/w Alarm	S
Telephone & Cable TV Hook-up - Exterior	S
TV - AC 20" Exterior TV in Baggage Compartment c/w Slide-out Tray	0

TV - AC 20" Color Stereo TV c/w Remote in Bedroom	S
TV - AC 32" Color Stereo TV c/w Remote in Entertainment Cabinet Rear of Slide Out	S
TV Antenna - Roof Top Retractable Antenna c/w Booster	S
VCR - HiFi Video Cassette Recorder	S

#### HEATING, VENTILATING AND AIR CONDITIONING

Air Conditioner - Dual Ducted (2) 13,500 BTU	S
Furnace - 40,000 BTU Central Furnace c/w Electronic Ignition and In Floor Ducting	S
Heater - Dual Rear Auxiliary Automotive Heaters c/w Electric Valve	S

#### ELECTRICAL

Alarm System c/w 2 Motion Detectors	0
Batteries - 4 x 6V Deep Cycle Auxiliary Battery c/w Slide Out Battery Tray	S
Bi Directional Isolator Relay Delay (BIRD) Battery Charging System	S
Generator - 6.5 KW Onan LP Gas Marquis (will not start below -8C) with Air Assist Slide Out	0
Generator - 7.5 KW Onan Quiet Diesel With Air Assist Slide out	S
Generator Ready Package	S
Inverter - 2000 Watt Inverter c/w 100 Amp Charger	S
Panel - 50 Amp Electrical Service c/w Energy Management System	S
Pre-wire - 110V/12V Receptacles in Baggage Compartment (Freezer Prep)	S
Pre-wire - for Solar Panel	S
Pre-wire For Power Main Awning	S
Switch - Electronic Battery Disconnect (Coach Batteries)	S

#### PLUMBING AND LP SYSTEMS

Black Tank Flush System	S
Holder - Swing Out Under Body Sewer Hose Holder	S
Holding Tanks - Enclosed and Insulated, Dual Heated Waste Holding Tanks	S
LP Tank - Easy Access Propane Tank	S
Switch - 3-Way Water Pump Switching	S
Water Heater - Electronic Ignition Gas/Electric/Motoraid Water Heater (10 Gal)	S
Water Tank - Enclosed and Insulated, Dual Heated Fresh Water Tank	S
Winterization System - c/w Potable Antifreeze Pick Up Tank	S

#### SYSTEMS

Central Vacuum - With Outlet in Baggage Compartment	S
Freezer / Refrigerator - On Slide Out Tray 1.38 Cu. Ft. (AC/DC)	0
Rear-view Camera/Monitor – Color LCD Display Mounted in Dash	S
Washer/Dryer (vented)	0

#### AWNING PACKAGES

Awning - Elite Slide Toppers (Aluminum Weather Shield)	0
Awning - Patio A&E Elite 9000 - 21 Ft.	0
Awning - Patio A&E Weather Pro Power (Aluminum Weather Shield)	0
Windsensor w/ Remote	0
Awning - Three Elite Window (Aluminum Weather Shield)	0
Factory P.D.I.	0

# FLOORPLANS

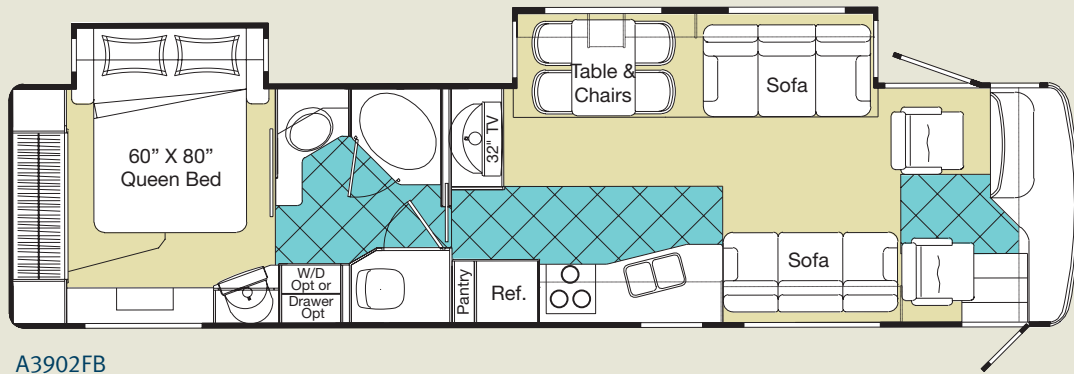

A3902FB

# SPECIFICATIONS

## A3902FB

CHASSIS: FREIGHTLINER XC SERIES	
ENGINE: 400HP CUMMINS TURBO DIESEL	
GVWR-LBS(KG)	32000(14545)
UVW-LBS(KG)	25783(11719)
NCC-LBS(KG)	6217(2826)
WHEELBASE-IN(MM)	252"(6401)
LENGTH-FT(MM)	38'10"(11836)
WIDTH-FT(MM)	8'4"(2534)
HEIGHT INCL.A/C-FT(MM)	12' 3"(3734)
**WATER TANK CAP.-GAL(L)	102(386)
HOLDING TANK CAP GREY.-GAL(L)	57(216)
HOLDING TANK CAP. BLACK-GAL(L)	57(216)
FUEL CAP.-GAL(L)	100(379)
PROPANE CAP.-GAL(L)	32(121)
**-INCLUDES 10GAL WATER HEATER	

## NEW STANDARD FEATURES

- INDEPENDENT FRONT SUSPENSION
- 400 HP CUMMINS TURBO DIESEL
- 7.5 KW ONAN QUIET DIESEL GENERATOR
- SOLAR PANEL PREWIRE
- SATELLITE DISH PREWIRE
- DHS MOBILE THEATER SYSTEM
- FULL BODY EXTERIOR PAINT
- PREMIUM MATTRESS
- ULTRA LEATHER 8 WAY POWER SEAT WITH POWER FOOT REST ON PASSENGER SIDE
- 12 CU FT. SIDE BY SIDE REFRIGERATOR WITH ICE MAKER
- HEATED CERAMIC TILE FLOORING IN GALLEY AND LAVATORY
- POWER SUN VISORS



This combination of labels assures the purchaser that the manufacturer has met or surpassed CSA-CRVA-RVIA standards covering electrical services, gas services, plumbing services, and vehicular safety.

Empress motorhomes exceed 96 inches in width. In some states, 96 inches is the maximum width of vehicles travelling some or all state roads. It is the responsibility of the owner to be familiar with the road usage laws of the states in which you travel.



P.O. Box 1230, Winkler, MB  
 Canada R6W 4C4  
 Tel: (204) 325-4361  
 Fax: (204) 325-5241  
 www.tripleerv.com

Experience the Difference