

TRIPLE E QUALITY

A Triple E Regency Motorhome is a combination of first-class materials and quality controlled construction.

Built with a solid foundation, integrity is never compromised – inside or out.

Exteriors are virtually maintenance free and abrasion resistant. Leaks are prevented thanks to an EPDM roof membrane – which also contributes to energy-efficiency.

Cabinetry is constructed with screws rather than staples to ensure structural integrity and durability. Both strong and moisture repellent, the solid oak doors are a front to ample storage space.

Designer interior decors are a mixture of style and functionality – with quality fabrics developed to handle years of wear while meeting or exceeding flame retardant standards.

All Triple E products are built to CSA (Canadian Standards Association) or RVIA (Recreational Vehicle Industry Association) Standards. We were one of the first RV manufacturers to obtain the ISO 9002 certification – your assurance of the careful construction and high quality materials that are part and parcel of every Triple E Unit.



Triple E is proud to offer a

2 YEAR LIMITED WARRANTY

on structure as well as most major components. Please see your dealer for further details.



This combination of labels assures the purchaser that the manufacturer has met or surpassed CSA-CRVA-RVIA standards covering electrical services, gas services, plumbing services, and vehicular safety.

Regency Motorhomes exceed 96 inches in width. In some states, 96 inches is the maximum width of vehicles traveling some or all state roads. It is the responsibility of the owner to be familiar with the road usage laws of the states in which you travel.



P.O. Box 1230, Winkler, MB
Canada R6W 4C4
Tel: (204) 325-4361
Fax: (204) 325-5241
www.tripleerv.com

Brochure pictures may be shown with optional equipment.



Discover for yourself how the little things can make a big difference. View the entire family of Triple E products at www.tripleerv.com.

Experience the Difference

REGENCY 2003

Regency



Life is good!



The little things make a big difference

KEEP THE CAMPFIRE BURNING
PAST MIDNIGHT. STOP FOR ICE
CREAM WHENEVER POSSIBLE.
SEEK OUT THE BEACH WITH
VELVETY SAND. ON A REGENCY
HOLIDAY, YOU'LL BE SMILING
IN EVERY PICTURE.



DETAIL ORIENTED

Triple E's 2003 Regency makes the RV lifestyle accessible to more people. Stylish, spacious, and surprisingly affordable, this is one Class C Motorhome that is ready for anything.

Count on the Ford 6.8L V10 engine to get you where you need to go. Then when stopped, utilize the many standard amenities. If desired, customize with the optional features that best suit your needs including a 4 kilowatt generator, stereo with six stack CD changer, or microwave oven.

To extend your RV season, consider the optional XL package - which includes:

- » enclosed, insulated and heated holding tanks
- » thermal pane windows, and
- » radius baggage doors, and much more.

Available in four versatile floorplans, you'll find that the Regency has everything you need to make every trip carefree.



Please refer to our web site at www.tripleerv.com for more detailed explanations of our options.



Looks Count

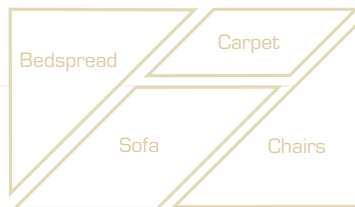

ALONG WITH YOUR CHOICE OF FOUR FLOOR PLANS AND A HOST OF OPTIONS, FURTHER CUSTOMIZE YOUR MOTORHOME WITH ONE OF THREE DISTINCT INTERIOR DESIGN SCHEMES. SELECTED BY A GROUP OF PROFESSIONALS, THE COMBINATIONS SKILLFULLY COORDINATE UPHOLSTERY, CARPETING, AND WINDOW TREATMENTS.



The Regency is equipped with Filon Filoplated smooth exterior sidewalls. Extremely dent and weather resistant, these panels will keep your motorhome looking its best for years to come.



NUTMEG



FERN MEADOW



BLUE HORIZON



For more information on the Regency's features, visit www.tripleerv.com.

Colors may not be exactly as shown due to the printing process. Please see your dealer for specific colors.



Exterior storage is a priority with our designers.



Raised solid oak cabinet doors enhance the rich oak finish cabinetry.



New for 2003 - a big button radio allows for quick visual adjustments.

ENDLESS APPEAL

Enhanced by oak cabinetry, the Regency's bright living area is suitable for both entertaining and relaxing.

Features such as extendable counter space and a pass through storage compartment will afford you the space you require.

Customize your motorhome with features such as air conditioning or a microwave to suit your needs.

To keep your travels hassle free, you'll appreciate the convenience of:

- » cruise control,
- » tilt steering,
- » power windows and locks, and
- » large folding side view mirrors.

And, for your added enjoyment, the standard Regency includes an in dash AM/FM stereo with CD player - as well as cable TV hookup.



STANDARDS AND OPTIONS

S = Standard O = Option **New** = New for 2003

VEHICULAR

	C22	C24	C28	C30G
Air Conditioning - Chassis	S	S	S	S
Block Heater	S	S	S	S
Chassis - Ford 11,500 GVW, E-350, 6.8l EFI V-10 Triton	S	-	-	-
Chassis - Ford 14,050 GVW, E-450, 6.8l EFI V-10 Triton	-	S	S	S
Chassis - Ford 14,050 GVW, E-450, 7.3 L. Power Stroke Diesel	-	O	O	-
Cover - Continental Cover for Spare Tire (included in XL option)	O	O	-	-
Hitch - Trailer Hitch Receiver w/ Wiring - 350/3500 lb	S	S	S	S
Light - High Mounted Rear Stop Light - LED Long Life	S	S	S	S
Mirrors - Automotive Styled Exterior Mirrors	S	S	S	S
Power Windows and Door Locks	S	S	S	S
Rear Airbag Assist Suspension	O	O	O	O
Seat - Power Drivers Seat	S	S	S	S
Wheel Simulators	O	O	O	O
Cruise Control and Tilt Steering Wheel	S	S	S	S
Spare Tire - Crank Down Under Floor Mount	-	-	S	S
Spare Tire w/Carrier c/w Vinyl Cover	S	S	-	-
Transmission - Automatic 4 Speed c/w Overdrive	S	S	S	S
Undercoating - Chassis	S	S	S	S
Wheel Discs	S	S	S	S
Tires - Radial Ply	S	S	S	S

CONSTRUCTION

Aluminum Framed/Vacuum Bonded Insulated Wall and Roof Construction	S	S	S	S
Floor - Steel Framed Vacuum Bonded Insulated Floor Construction	S	S	S	S
Sidewalls - FRP "Filon" Sidewalls	S	S	S	S
Windows - Tinted Radius Cornered Windows	S	S	S	S
Roof - One Piece EPDM Roof	S	S	S	S
Window - Front Bunk Window	O	O	O	-

EXTERIOR

Bumper - Rear Bumper c/w Aluminum Bumper Cover (non XL Models)	S	S	S	S
Ladder - Roof Rack & Ladder	O	O	O	O
Light - Porch Light with Interior Wall Switch	S	S	S	S
Running Boards - Fiberglass Flares & Running Boards	S	S	S	S
New Exterior Shower with Shut off Valves for Winterizing	O	O	O	O
Step - Electric Step (non XL Models only, included in XL Option)	O	O	O	O
Storage - Pass Through Storage Compartment at Rear	-	-	S	S

INTERIOR

Blind - Venetian Blind in Galley	S	S	S	S
Cabinet - Storage Cabinets on Sides of Overhead Bunk	S	S	S	S
Cabinets - Oak Finished Cabinet Construction	S	S	S	S
Detectors - Electronic Smoke, LP and CO Detectors	S	S	S	S
Doors - Raised Solid Oak Cabinet Doors	S	S	S	S
Drapes - Privacy Drape - Cab	S	S	S	S
Drapes - Privacy Drape - Bedroom	S	S	-	-
Fire Extinguisher - Dry Chemical	S	S	S	S
Flooring - Carpeted Bedroom & Living Areas	-	-	S	S
Flooring - Vinyl Flooring in Galley	S	S	S	S
Handle - Oak Assist Handle at Bunk	S	S	S	S
Magazine Rack - Oak Magazine Rack on Cab Wall	S	S	S	S
Shades - Pleated Shades	S	S	S	S
Shelf - Bedroom T.V. Shelf	-	-	O	O
Drawers - Dual Roller Glide Drawers c/w Travel Lock	S	S	S	S

FURNITURE

Bed - Twin Beds	-	-	O	O
Booth Dinette - Wall Mount Dinette Table w/ Steel Framing for Seat Belts w/ 5" Laminated Cushions	S	S	S	S
Chair - Swivel Cocktail Chair	-	S	-	-
Chair - Swivel Cocktail Chairs (2) with Oak Flip Table	-	-	S	-
Sofa - 62"	-	-	-	S

Sofa - Jackknife- 66" c/w Drawer in Lieu of Cocktail Chairs and Flip Table	-	-	O	-
Mattress - Innerspring 60" x 74"	-	-	S	S
Mattress - Innerspring 54" x 74"	S	S	-	-

GALLEY

Cook Top - 3 Burner Range/Oven w/ High Output Burner	S	S	S	S
Bi-Fold Range Cover	O	O	O	O
Microwave Oven	O	O	O	-
Microwave - Over the Range c/w Light and Vent Fan	-	-	-	S
Monitor Panel - Grey, Black, Fresh Water and Battery Charge	S	S	S	S
Range Hood - Lighted Power Range Hood	S	S	S	-
Refrigerator - Double Door 2-Way (Gas/ Electric) Fridge (6 cu. Ft.)	S	S	S	S
New Sink - Acrylic Deep Bowl c/w Cutting Board Cover	S	S	S	S
New Convection Microwave - OTR c/w Light and 110V Vent Fan w/ Cook Top and Drawers	-	-	-	O

LAVATORY

Fan - Power Bath Vent	S	S	S	S
Hooks - Robe Hooks in Shower	S	S	S	S
New Skylight - in Shower	O	O	O	O
New Toilet - Foot Flush	S	S	S	S

ENTERTAINMENT

Entertainment Console - Over Cab with 20" AC TV and Slide out Single Bed (N/A with Diesel Option)	O	O	O	-
Entertainment Console - Over Cab with 20" AC TV	-	-	-	O
New Stereo - AM/FM Cassette in Dash Stereo w/ Separate 6 Disk CD Changer w/ Big Buttons - 80 Watt	O	O	O	O
New Stereo - AM/FM CD in Dash Stereo w/ Big Buttons - 80 Watt	S	S	S	S
New Stereo - AM/FM CD Stereo c/w 6 Stack in Dash CD Changer w/ Big Buttons - 80 Watt	O	O	O	O
TV - 12V DC 13" Color w/ Remote Control	O	O	O	O
TV Antenna - Roof Top Retractable Antenna c/w Booster	O	O	O	O

HEATING, VENTILATING AND AIR CONDITIONING

Air Conditioner - 13,500 BTU Roof Air Conditioner with Protective Coil Screen	O	O	O	O
Fan - Thermal Controlled Fan (Front Bunk Area)	O	O	O	O
Furnace - 31,000 BTU Furnace with in Floor Ducting	S	S	S	S
Heater - Rear Auxiliary Heater (Non XL Models Only, included in XL Option)	O	O	O	O

ELECTRICAL

Battery - Second RV Coach Battery (1 Standard)	O	O	O	O
Bi-Directional Isolator Relay Delay (BIRD) Battery Charging	S	S	S	S
Cable TV Hook-up	S	S	S	S
Converter - Power Converter c/w Battery Charger	S	S	S	S
Cord - 25 Ft. Power Cord	S	S	S	S
Generator - 4.0 KW Onan MicroQuiet®	O	O	O	O
Generator Ready Package	O	O	O	O
Receptacle - GFI Patio 110 V Receptacle	S	S	S	S

PLUMBING AND LP SYSTEMS

Black Tank Flush	S	S	S	S
Valve - Water Heater By-Pass Valve	S	S	S	S
Water Heater - Electronic Ignition LP Water Heater	S	S	S	S

OPTIONAL AWNING PACKAGES

Awning - A&E 8500 Patio Awning - Vinyl	O	O	O	O
Factory PDI	O	O	O	O

SPECIAL OPTIONS PACKAGE(S)

XL PACKAGE INCLUDES:	-	O	O	O
Continental Tire Cover, Electric Step, Light Package in Baggage Compartments, Painted Skirts, Thermal Pane Windows, Fiberglass Front & Rear Mask (N/A C30G), Enclosed, Insulated & Heated Holding Tanks, Rear Auxiliary Heater, Slide Out Battery Tray, Radius Baggage Doors (flush Mount), Radius Entrance Door, Fabric Headliner, Heat Strip Added to Air conditioner				

SPECIFICATIONS

REGENCY 2003	C22	C24
GVWR - lbs (kg)	11500(5216)	14050(6373)
UVW - lbs (kg)	9167(4158)	9558(4336)
NCC - lbs (kg)	2333(1058)	4492(2037)
Engine	6.8L V10 Triton	6.8L V10 Triton
Wheelbase - inches (mm)	158(4013)	158(4013)
Length - feet (mm)	22'11"(6985)	24'3"(7391)
Width - feet (mm)	8'4"(2534)	8'4"(2534)
Height Incl. A/C - feet (mm)	10'8"(3251)	10'8"(3251)
* Water Tank Cap. - gal (l)	36(137)	36(137)
Holding Tank Cap. - gal (l)	64(243)	64(243)
Fuel Capacity - gal (l)	55(208)	55(208)
Propane Capacity - gal (l)	17.5(66)	17.5(66)
Opt. Awning Length - feet (mm)	10'(3048)	11'(3353)

REGENCY 2003	C28	C30G
GVWR - lbs (kg)	14050(6373)	14050(6373)
UVW - lbs (kg)	10666(4838)	11328(5138)
NCC - lbs (kg)	3384(1535)	2722(1235)
Engine	6.8L V10 Triton	6.8L V10 Triton
Wheelbase - inches (mm)	190(4826)	208(5283)
Length - feet (mm)	28'7"(8712)	30'3"(9220)
Width - feet (mm)	8'4"(2534)	8'4"(2534)
Height Incl. A/C - feet (mm)	10'8"(3251)	10'8"(3251)
* Water Tank Cap. - gal (l)	36(137)	36(137)
Holding Tank Cap. - gal (l)	64(243)	64(243)
Fuel Capacity - gal (l)	55(208)	55(208)
Propane Capacity - gal (l)	17.5(66)	17.5(66)
Opt. Awning Length - feet (mm)	18'(5486)	20'(6096)

GVWR

GROSS VEHICLE WEIGHT RATING means the maximum permissible weight of this motorhome. The GVWR is equal to or greater than the sum of the unloaded vehicle weight (UVW) plus the net carrying capacity (NCC).

UVW

UNLOADED VEHICLE WEIGHT means the weight of the motorhome as built at the factory with full fuel, engine oil, and coolants. The UVW does not include cargo, fresh water, LP gas, occupants, or factory or dealer installed accessories.

NCC

NET CARRYING CAPACITY WEIGHT means the maximum weight of all occupants, including the driver, personal belongings, food, fresh water, LP gas, tools, tongue weight of towed vehicle, factory and dealer installed accessories, etc., that can be carried by this motorhome. NCC is equal to or less than GVWR minus UVW.

NOTE: Please see your dealer for weights of factory installed options.

FLOORPLANS

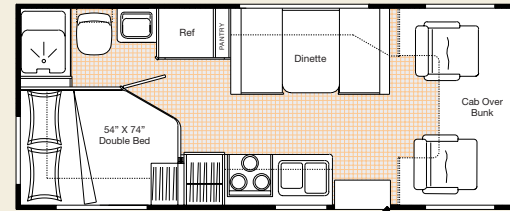

C22

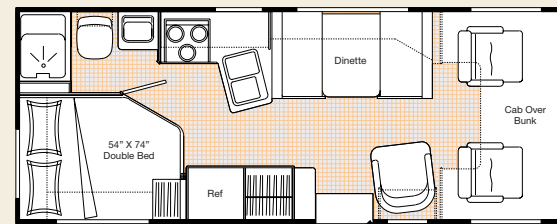

C24

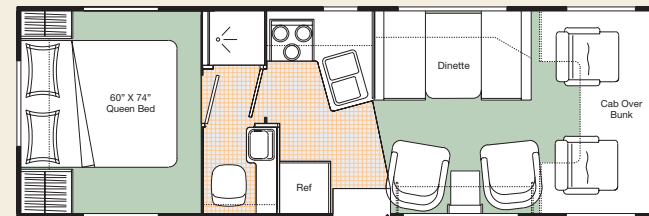

C28

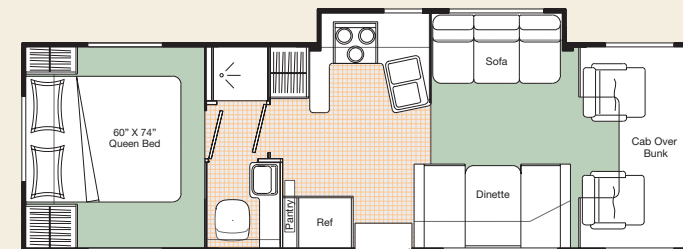

New C30G

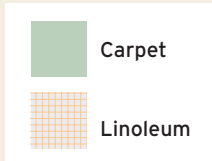

Product improvement is a continuing process at Triple E Recreational Vehicles. Thus, we reserve the right to change specifications on any or all products without prior notice; errors and omissions excepted. Triple E Recreational Vehicles is under no obligation to undertake modification to units manufactured prior to changes on specifications.