

Regency 2008

Follow your dream

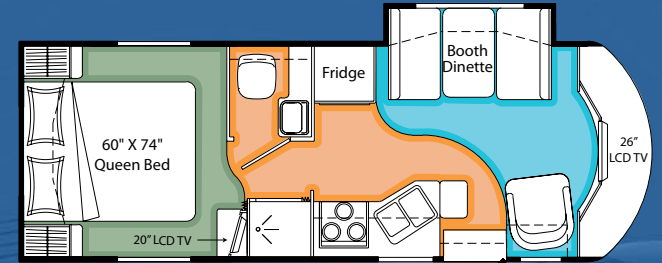

RECREATIONAL VEHICLES



GT27S

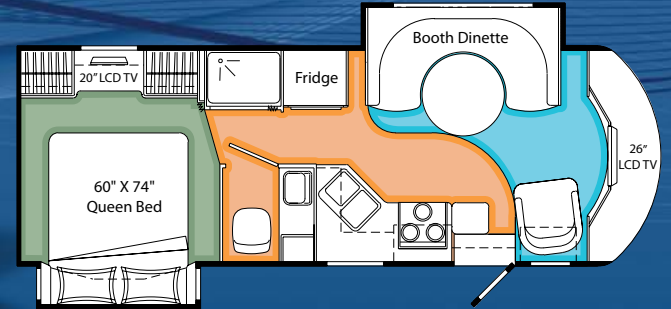

GT28DB

Vinyl Carpet Optional Carpet



Décor

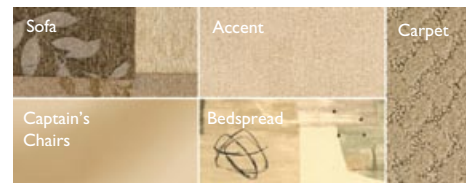

Northern Grassland



Tuscan Sun



Merlot



River Reflection

STANDARDS AND OPTIONS

	GT27S	GT28DB
CHASSIS AND SUSPENSION		
Block Heater	S	S
Chassis - Ford 14,050 GVW, E-450, 6.0 L. Powerstroke Diesel w/ LP Generator Ready	0	0
Chassis - Ford 14,050 GVW, E-450, 6.8L EFI V-10 Triton w / Gas Generator Ready	S	S
Concealed Locking Fuel Filler	S	S
Hitch - Trailer Hitch Receiver w/ wiring - 500/5000 lb	S	S
Spare Tire w/Carrier and Continental Cover	S	S
Tires - Radial Ply	S	S
Transmission - Automatic 5 Speed c/w Overdrive and Tow Haul Mode	S	S
Wheel Simulators	S	S
DRIVERS AREA CONVENIENCES		
Air Conditioning - Chassis	S	S
Cruise Control and Tilt Steering Wheel	S	S
Mirror - Interior Rear View Mirror	S	S
Power Windows and Door Locks	S	S
08 Rear View Camera/Monitor – 5" Color - now standard for '08	S	S
Seat - Leather Look Driver's and Passenger's Chairs	S	S
Seat - Power Driver's Seat	S	S
Switch - Battery Selector Switch for Radio	S	S
Wood Look Dash Trim	S	S
VEHICULAR		
Light - High Mounted Rear Stop Light – LED Long Life	S	S
Rust Protection	0	0
Undercoating - Chassis	S	S
CONSTRUCTION		
Floor - Steel Framed Vacuum Bonded Insulated Floor Construction	S	S
Roof - Domed Kemlite FRP Flexroof	S	S
Vacuum Bonded Aluminum Framed Insulated Domed Roof Construction	S	S
Vacuum Bonded Aluminum Framed Insulated Sidewall with Thermal Break	S	S
08 Vacuum Bonded Gel Coat Vetrolite Fiberglass Sidewalls	S	S
Windows - Tinted Radius Cornered Windows	S	S
EXTERIOR		
Doors - Exterior Flush Radiused Style Baggage Doors	S	S
Exterior Assist Handle - Monogrammed	S	S
Fiberglass Front and Rear Mask	S	S
Light - Scare Light w/ Interior Wall Switch	S	S
Running Boards - Fiberglass Flares & Running Boards	S	S
Storage - Pass Through Storage Compartment at Rear	S	
Storage - Additional Exterior Storage Added for 2008		S
INTERIOR		
08 Cabinets - Alder Finished Cabinet Construction w/ Raised Solid Cabinet Doors and Cabinet Ends	S	S
Ceiling - Flat Padded Vinyl Headliner	S	S
Detectors - Electronic Smoke, LP and CO Detectors	S	S
Drapes - Privacy Drape – Cab	S	S
Drawers - Full Extension Ball Bearing Drawer Tracks	S	S
Fire Extinguisher - Dry Chemical	S	S
Flooring - Carpet in Living Area as per floorplan	0	0
Flooring - Carpeted Bedroom, Vinyl Flooring in Galley and Living Area	S	S
08 Lighting - Fluorescent Aisle Lighting	S	S
Shades - Pleated Day/ Night Shades	S	S
Skylight - Living Area	S	S

	GT27S	GT28DB
FURNITURE		
Booth Dinette - Wrap Around Booth with Round Drop Leaf Table and Roll Out Drawers w/ 5" Laminated Cushions		S
08 Booth Dinette w/ 5" Laminated Cushions and Dinette Table w/ Solid Wood Trim and Roll Out Drawers	S	
Chair - Swivel Cocktail Chair	S	S
Pillows - Coordinated Pillows For Living Area	S	S
GALLEY		
08 Cooktop - 3 Burner Range w/ High Output Burner - Stainless Look	S	S
Countertop - Radiused Solid Wood Trim on Counter tops	S	S
Faucet - Brushed Nickel Galley Faucet with Pull out Sprayer	S	S
08 Refrigerator - Dometic Double Door LP/Electric 7 Cu. Ft. Stainless Look	S	S
Sink - Nickel Look Large Acrylic Deep Bowl Sink	S	S
LAVATORY		
Hooks - Robe Hooks in Shower	S	S
Shower - Tub / Shower	S	S
Skylight - in Shower	S	S
Toilet - Sealand Traveller Lite - China - Foot Flush w/ Sprayer	S	S
BEDROOM		
Bedsread - Decorative Bedsread with Toss Cushions in Bedroom	S	S
Mattress - Innerspring 60" x 74"	S	S
Shades - Pleated Day / Night / Black Out Shades	S	S
ENTERTAINMENT		
Bedroom TV - LCD TV	0	0
CD Changer - 10 Stack CD Changer	0	0
08 Entertainment Console - Over Cab with 26" LCD Flat Screen AC TV	S	S
Satellite Dish - Winegard with Electronic Elevation Sensor	0	0
Satellite Radio - Prewire including Satellite Antenna (Subscription not Included)	0	0
08 Stereo - AM/FM/CD/MP3 Sirius Ready Player in Dash w/ Wireless Remote and Auxiliary Input	S	S
TV Antenna - Roof Top Retractable Antenna c/w Booster	S	S
HEATING, VENTILATING AND AIR CONDITIONING		
Air Conditioner - Low Profile 13,500 BTU Ducted Roof Air Conditioner c/w Heat Strip	S	S
Fan - Reversible Thermal Controlled Create A Breeze Fan in Bedroom ILO Manual Vent	0	0
Fan - Reversible Thermal Controlled Create A Breeze Fan in Galley or Living Area ILO Manual Vent	0	0
Furnace - 35,000 BTU Furnace	S	S
Vent - 12 Volt Power Roof Exhaust in Lavatory	S	S
Vent - Manual Screened Roof Vent in Galley or Living Area, and Bedroom	S	S
ELECTRICAL		
Battery - Second RV Coach Battery (1 Standard)	0	0
Bi-Directional Isolator Relay Delay (BIRD) Battery Charging	S	S
Cable TV Hook-up	S	S
Converter - Power Converter c/w Battery Charger (45 Amp)	S	S
Cord - 25 Ft. Power Cord	S	S
Generator - 3.6 KW Onan MicroQuiet® LP Generator w/ Auto Changeover Switch (Available only with 6.0L Diesel Engine Only)	0	0
Generator - 4.0 KW Onan MicroQuiet® w/ Auto Changeover Switch (N/A with 6.0 L Diesel Engine Option)	S	S
Prewire - for Fantastic Fan In Living and Bedroom Areas (Where Applicable)	S	S
Prewire - For Rear Camera Monitor	S	S
Receptacle - GFI Patio 110 V Receptacle	S	S
Switch - 12 Volt Battery Disconnect - Manual	S	S
Tray - Slide Out Battery Tray	S	S

	GT27S	GT28DB
PLUMBING AND LP SYSTEMS		
Black Tank Flush	S	S
Monitor Panel - Grey, Black, Fresh Water and Battery Charge	S	S
Pick Up Kit - Antifreeze Pick Up Kit	S	S
Valve - Water Heater By-Pass Valve	S	S
Water Heater - Electronic Ignition LP/ Electric/ Motoraid Water Heater	S	S
OPTIONAL AWNING PACKAGES		
Box Awning 11.5'	S	S
Slide Topper Awning (Quantity Shown)	1	2
SYSTEMS CERTIFICATION		
CSA Certification	S	S
RVIA Certification	0	0
Factory PDI	0	0
XL PACKAGE INCLUDES:		
Electric Step	S	S
Enclosed, Insulated & Heated Holding Tanks	S	S
Light Package in Baggage Compartments	S	S
Rear Auxiliary Heater	S	S
Thermal Pane Windows	S	S
CUSTOMER VALUE PACKAGE (Mandatory Option)		
Bi-Fold Range Cover	0	0
Exterior Shower	0	0
Ladder - Exterior Ladder	0	0
08 Micro / Convection - OTR c/w Light and 110V Vent Fan w/ Cooktop and Drawers - Stainless Finish	0	0
Mirrors - Heated Remote Mirrors	0	0
08 Paint - Full Body Exterior Paint w/ Clear Coat	0	0
Rear Airbag Assist Suspension	0	0
Stereo - AM/FM/DVD/CD/Tuner Home Theater with Cube Speakers	0	0

08 New for 2008 Standard Feature Optional Feature

SPECIFICATIONS

REGENCY 2008	GT27S	GT27S	GT28DB	GT28DB
CHASSIS FORD (GAS) Engine - 6.8L V10 Triton Trans. - 5-Speed TorqShift w/OD	STD		STD	
CHASSIS FORD (DIESEL) Engine - 6.0L V8 Turbo Trans. - 5-Speed TorqShift w/OD		0		0
GVWR-LBS(KG)	14500(6579)	14500(6579)	14500(6579)	14500(6579)
UWV-LBS(KG)	11221(5091)	TBD	11691(5304)	11784(5347)
NCC-LBS(KG)	3279(1488)	TBD	2809(1275)	2716(1232)
WHEELBASE-IN(mm)	185(4699)	185(4699)	190(4826)	190(4826)
LENGTH Not incl. spare-FT(mm)	27'8"(8433)	27'8"(8433)	28'1"(8560)	28'1"(8560)
WIDTH-FT(mm)	7'11"(2420)	7'11"(2420)	7'11"(2420)	7'11"(2420)
HEIGHT Incl.A/C-FT(mm)	10' 6.5"(3213)	10' 6.5"(3213)	10' 6.5"(3213)	10' 6.5"(3213)
WATER TANK CAP.Incl.w/h-GAL(L)	36(137)	36(137)	36(137)	36(137)
HOLDING TANK CAP.-GAL(L)	64(243)	64(243)	64(243)	64(243)
FUEL CAP.-GAL(L)	55(209)	55(209)	55(209)	55(209)
PROPANE CAP.-GAL(L)	17.5(66)	17.5(66)	17.5(66)	17.5(66)

All Capacities in U.S. Gallons / All weights are with gas engine / Add 7" to total length for Spare Tire



Triple E Recreational Vehicles
 Telephone: (204) 325-4361 Fax: (204) 325-5241 www.tripleev.com

Triple E Recreational Vehicles meet or surpass CSA-CRVA-RVIA standards covering electrical services, gas services, plumbing services and vehicular safety. It is the responsibility of the owner to be familiar with the road usage laws of the states in which you travel. Product improvement is a continuing process at Triple E Recreational Vehicles. Thus, we reserve the right to change specifications on any or all products without prior notice; errors and omissions excepted. Triple E Recreational Vehicles is under no obligation to undertake modification to units manufactured prior to changes on specifications. Brochure pictures may be shown with optional equipment. Colours may not be exactly as shown due to the printing process. Please see your dealer for specific colours.